



## RT29 Fuse with Cylindrical Cap

### 1. General

RT 29 type fuse with cylindrical cap applies to distribution configuration of AC 50Hz, rated voltage 500V and rated current of 125A for protection from overload and short-circuit. (This type of fuse is not recommended of using in the electric capacity cabinet, if so, RT36-00 shall be used as replacement). Fuse equipped with impinger can be used as open-phase protection for the electric motor. Fuse-link for general service with full range of breaking capacity shall be "gG" type which can be used for line protection. Fuse-link for electric motor protection with partial range of breaking capacity "aM" can be used for short-circuit protection of the electric motor.

### 2. Type designation

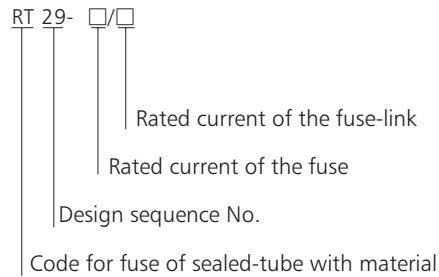

### 3. Technical data

#### 3.1 Parameters of fuse protector supporter (pedestal)

Model	Similar models at home and abroad	Rated voltage(V)	Rated current(A)	Length C	D	Width E	Height H	Mounted bolts K
RT29-16	RT19-16, aM1	500	16	70	31	20.2±0.22	45	M3
RT29-32	RT19-32, aM2	500	32	81	35	24	56.5±1.2	M4
RT29-63	RT29-63, aM3	500	63	90	-	31	39	M5
RT29-125	RT29-125, aM4	500	125	108	-	37.8	50	M6

#### 3.2 Parameter of fuse-link

Model	Similar models at home and abroad	Size (B×A)	Rated voltage(V)	Rated current(A)	Dissipation power(W)	Breaking capacity(kA)	Weight (kg)
RT29-16(RO14)	RT19-16	8.5×31.5	500	2, 4, 6, 8, 10, 16	≤2.5	100	0.0045
RT29-32(RO15)	RT19-32	10×38	500	2, 4, 6, 8, 10, 16, 20, 25, 32	≤3	100	0.009
RT29-63(RO16)	RT19-63	14×51	500	10, 16, 20, 25, 32, 40, 50, 63	≤5	100	0.022
RT29-125(RO17)	RT19-125	22×58	500	25, 32, 40, 50, 63, 80, 100, 125	≤9.5	100	0.06

# Fuses

## 3.3 Fuse holder (chassis) and parameter of configuration of fuse-link

Fuse holder (chassis) Model	Supporting fuse protector		
	Size(mm)	Model of fuse links	Current(A)
RT29-16	8.5×31.5	RT29-16	2, 4, 6, 8, 10, 16
RT29-32	10	RT14-20, RT28-32, RT29-32	2, 4, 6, 8, 10, 16, 20
RT29-63	14	RT28-63, RT14-32, RT29-63	2, 4, 6, 8, 10, 16, 20, 25, 32
RT29-125	22	RT14-63, RT29-125	25, 32, 40, 50, 63, 80, 100, 125

## 4. Schematic diagram

Fuse chassis used with fuse-link

Matched schematic diagram of fuse protector supporter (pedestal) and fuse links with size of 10×38

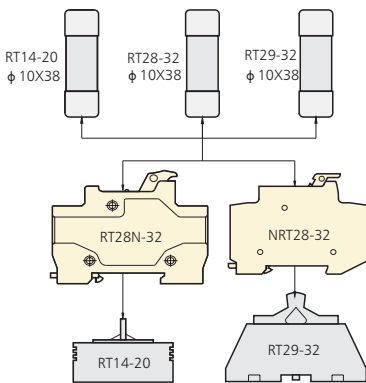

Matched schematic diagram of fuse protector supporter (pedestal) and fuse links with size of 14×51

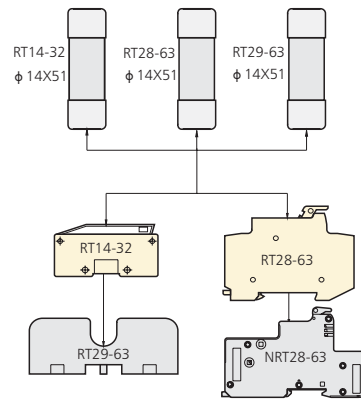

Matched schematic diagram of fuse protector supporter (pedestal) and fuse links with size of 22×58

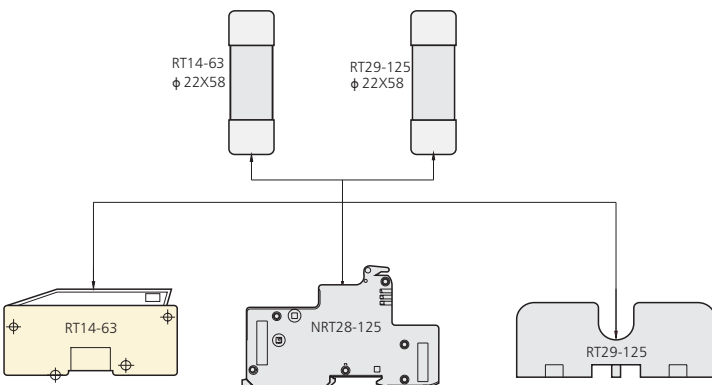

5. Overall and mounting dimensions

RT29-16 RT29-32 Chassis

RT29-16~125 Fuse-link

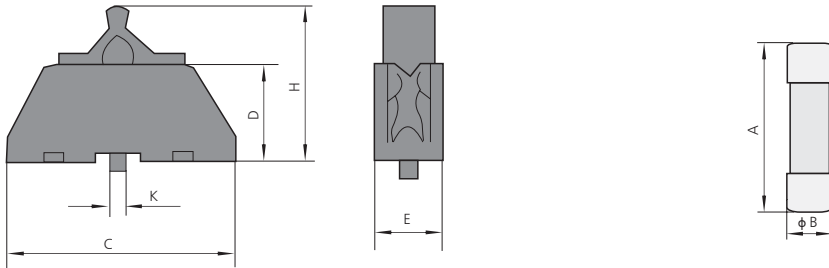

RT29-63 RT29-125 Chassis

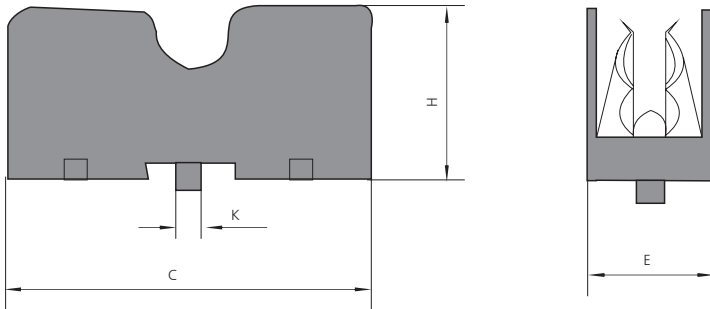

RT29-16 fuse used with RT29-16 chassis or RT29-16D chassis

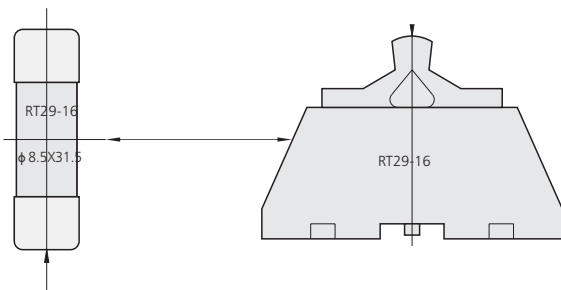

6. Ordering information

6.1 Specifications must be made when ordering:

6.1.1 Fuse-link shall refer to product model, rated current and quantity.

6.1.2 Fuse holder (chassis) shall define the type specification, indicate the chassis, number of poles and number of orders.

6.2 Examples for ordering: RT14-20 100 pieces, represents as the fuse-link with ordering No. RT29-32 with rated current of 16A fuse-link can only be written as RT 14-20/16A, 100 pieces.

RT29-32 (chassis) 100 pieces, represents as the fuse chassis with ordering No. RT29-32, 100 pieces.

# Fuses

## RT28, RT29 Fuse with Cylindrical Cap Protection Characteristic Curve

